

Do's and Don'ts on Site

Site storage

Bearers should be placed on a level, hard and dry surface. A waterproof covering must be used to protect components against rain and sun and to allow good air circulation. In vertical storage, bearers must be high enough to keep rafter overhangs clear of the ground. In horizontal storage, bearers must be arranged at close centres to give level support.

Fit it right

Fixing problems are eliminated in roof construction by the use of proprietary Builder Products. Proprietary joist hangers, restraint straps, connector plates, framing anchors, truss clips and shoes save time, money and produce a quality job. Your MiTek fabricator will advise you as to the right products for the job.

Think don't cut

Trussed rafters are designed and fabricated for a particular purpose - and to save work. Trusses must not be cut under any circumstance. Truss spacings can usually be adjusted to take hatch openings and chimney breasts. For large chimney breasts, trusses are specially designed and supported. Don't cut or guess, consult your trussed rafter supplier if you are in doubt.

Handling

Care in the handling trusses must be taken at all times. 'See-sawing' trusses on walls or scaffolding must be avoided and where necessary an extra man should be used to prevent the truss being distorted. Large trusses handled mechanically should be adequately supported.

Bracing

The Building Designer will have detailed the permanent roof bracing. Permanent roof bracing is required to ensure the stability of the roof. Each roof requires longitudinal and diagonal bracing. In specific cases bracing is also required to stabilise long web members. Temporary bracing must be fixed during erection to ensure that trusses are maintained in a vertical plane.

Support your tank

The extra load of a water tank requires careful support. Additional trimmers across the joists support the bearers.



**DO STORE ON
SITE CAREFULLY**

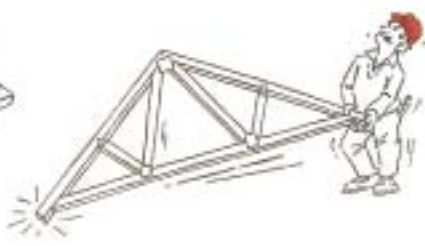

**DO HANDLE WITH
CARE**



**DO FIX IT
RIGHT**



**TRUSSES DO NEED
BRACING**



DON'T CUT



**DO SUPPORT
YOUR TANK**

IF IN DOUBT - ASK!